

Motorized solutions for interior blinds.

RolPro Motorized

Operating the RolPro roller blind system is very smooth in its manual, as well as in the motorized version. We have specially selected an ultra silent tubular motor with an optimised gear to offer a perfect user experience.

Specially designed brackets allow removal and adjustment of the motor without any special tools as the motortube is simply snapped into the corresponding holders.



Quick Facts RolPro Motorized

Motor Diameter	35 mm
Power Input	230 Volts AC / 50 Hz
Protection level	IP 44
Running time	4 Minutes
Operation temp.	-10°C / +40°C

Motor Types Comparison

	TBM-3ML	TBM-6ML	TBM-3ELR	TBM-6ELR
Torque	3 Nm	6 Nm	3 Nm	6 Nm
Rotations / Min.	30 RPM	20 RPM	30 RPM	20 RPM
Power Consumpt.	90 Watts	120 Watts	90 Watts	120 Watts
Noise Level	39 DB (A)*	39 DB (A)*	39 DB (A)*	39 DB (A)*

(*) Average noise level of the motor that is recorded in an acoustic room at a distance of 1m. Technical data are subject to change.

Motorized solutions for interior blinds.



Huegin-Trietex GmbH
 Dammstraße 5a
 79588 Efringen-Kirchen
 Germany

Phone +49 7628 9100 0
 Fax +49 7628 9100 40
 info@huegin-trietex.com
 www.trietex.com



Technical information at a glance:

Gear dimensions without bracket	71.4 x 71.4 x 12.8 mm
Minimum light gap	17 mm
Operation	Chain operation, tubular motor operation
Inside tube diameter	41 mm
Outside tube diameter	45 mm
Maximum width	200 gr/m ² – 2.00 m 300 gr/m ² – 1.80 m
Maximum drop	200 gr/m ² – 3.00 m 300 gr/m ² – 2.50 m
Maximum fabric weight	Rolpro 2 kgs New: Rolpro Plus: 4 KGs
Hembars	Oval hembar approx. 34.6 x 15.2 mm Rectangular hembar 30 x 8 mm and 41 x 11 mm
Colours of the gear	White and grey,

All technical data are subject to change without further notice.

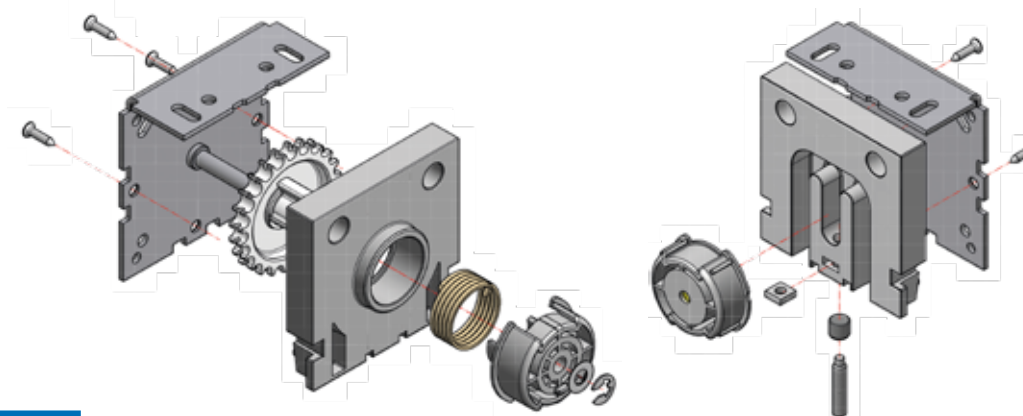

ROLPRO

roller blind system.



RolPro Single

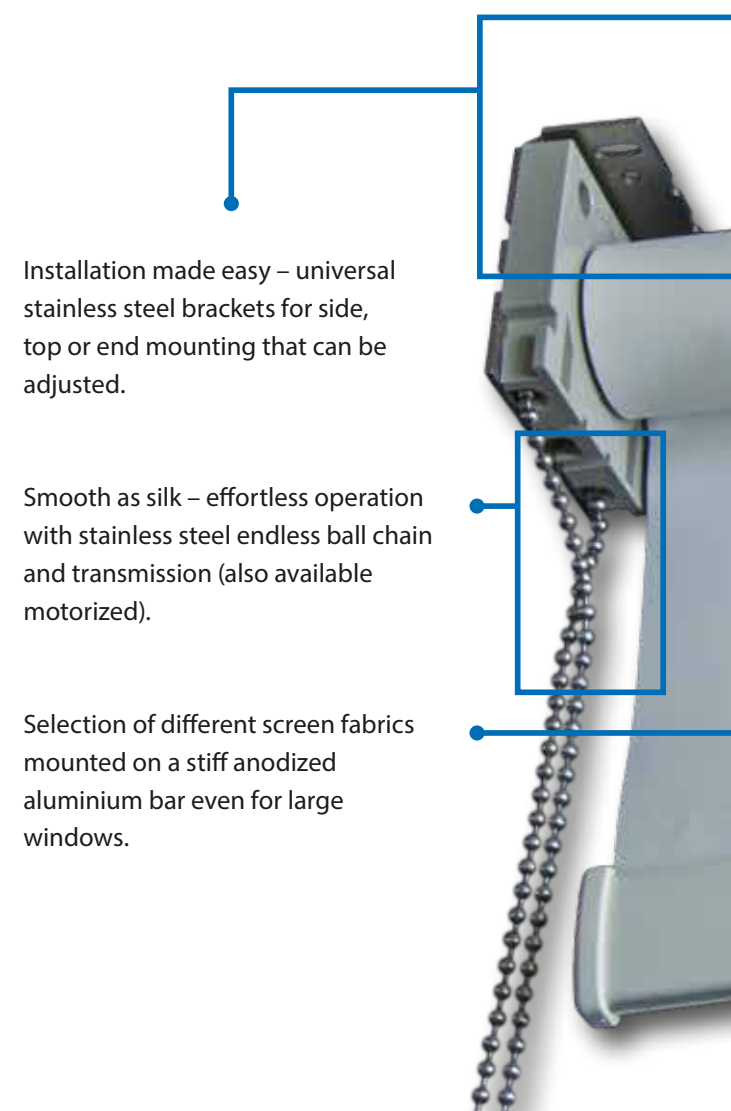

Installation made easy – universal stainless steel brackets for side, top or end mounting that can be adjusted.

Smooth as silk – effortless operation with stainless steel endless ball chain and transmission (also available motorized).

Selection of different screen fabrics mounted on a stiff anodized aluminium bar even for large windows.

Motorized solutions for interior blinds.

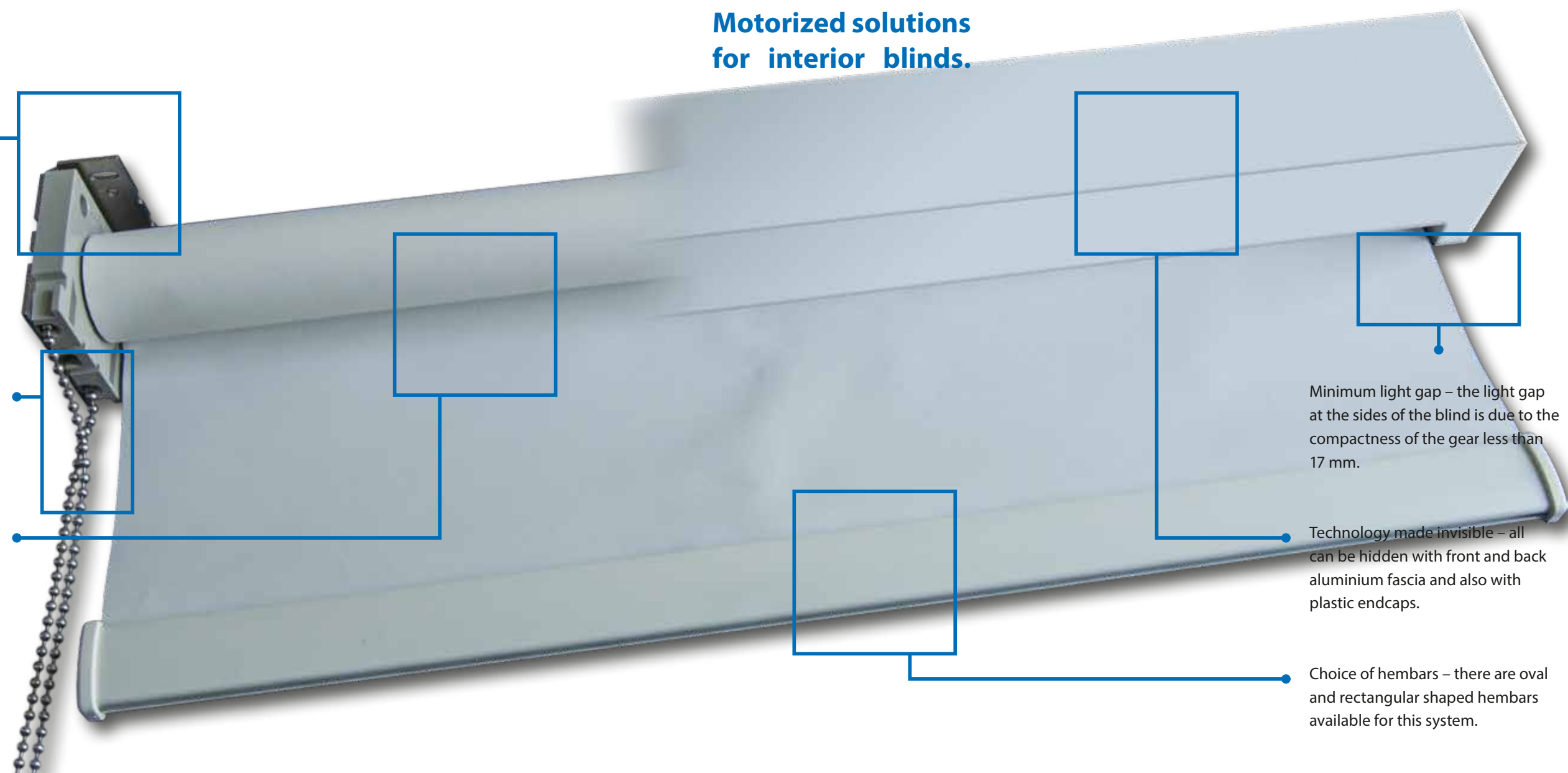

Minimum light gap – the light gap at the sides of the blind is due to the compactness of the gear less than 17 mm.

Technology made invisible – all can be hidden with front and back aluminium fascia and also with plastic endcaps.

Choice of hembars – there are oval and rectangular shaped hembars available for this system.

RolPro Double

Ideally for combining with a blackout fabric is the RolPro Double bracket. Two RolPro gears mounted on a stainless steel bracket.

Bracket can be used either for wall or ceiling mounting and even be changed on site. Operation can be manually by chain or motorized or even mixed.

The lower part of the roller blind can be covered by a fascia. A full cover of the front is available on request.

Quick Facts RolPro Double

Dimensions	150x146 mm
Colour Base Plate	Stainless Steel
Colour Gear	white or grey. Other colors on request
Mounting Options	Wall or ceiling
Operation Options	Manual or motorized

Motorized solutions for interior blinds.

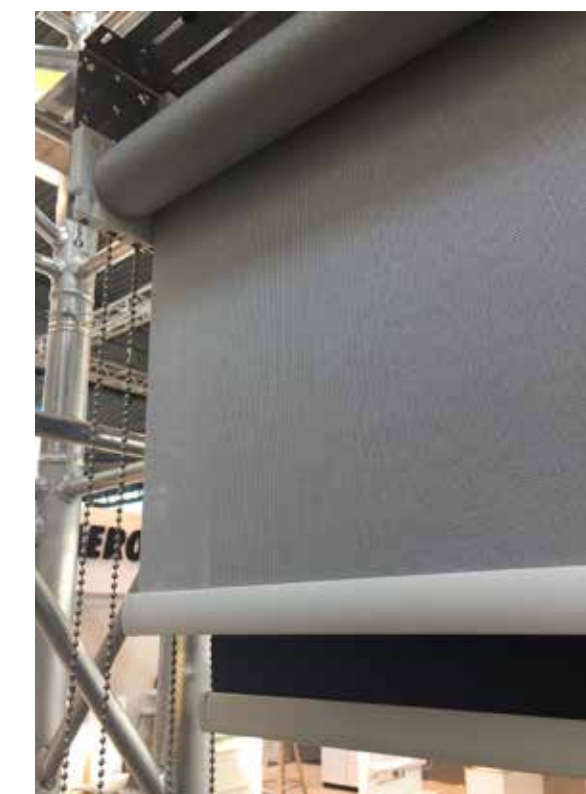

Product Features:

ROLPRO roller blind system – smooth in operation with rock solid durability.

This versatile roller blind system was developed especially with the demands of commercial projects in mind.

No compromises – easy installation, smooth operation and long lasting quality. It all comes in a timeless and understated design that puts the architecture of the building at first place. Developed and manufactured in Germany.

Installation made easy. Self adjusting mounting brackets made of stainless steel for side, top or end mounting.

Horizontal adjustment of the 41 mm inside diameter aluminium tube by simply adjusting an Allen head screw. The tube with the screen fabrics can be taken out easily by just lifting it up and a short horizontal movement.

Design as you need it. Fascias for front, back and sides can be added by simply clipping them on – hiding and protecting the roller blind system.



Rolpro Plus - suitable for fabric weights of up to 4 kgs.

Smooth as silk. Even large sized roller blinds can be operated without effort and friction. The stainless steel ball chain slides easily through the gear made of high performance plastics.

Rock solid. Stainless steel brackets with a thickness of 2 mm, stainless steel operating cord, strong aluminium bars and carefully chosen plastic materials leave no possibilities for failure.

Minimum light gap. The roller blind gear is just about 13 mm thick leaving a light gap of less than 17 mm at each side of the roller blind providing seamless sun protection.

Well guided. Guide wires or side channels are of course also available for the RolPro roller blind system.

